



RAMCO
TILE
GROUT
CEMENT POLYMER GROUT

Ramco Tile Grout is a top-notch cement-based, polymer-modified mortar for filling tile joints. It's made with binders, polymers and fillers for strong binding and excellent water resistance.

Ramco Tile Grout is a pre-packed tile grout combining cement with selected pigment and several admixtures.

Two component
Epoxy
variants
also available



Features

Joint Filling: It fills spaces between tiles, preventing the accumulation of dirt and moisture. This guards against potential damage over time.

Expansion and Contraction: Accommodates tile expansion and contraction during temperature changes, preventing cracks caused by thermal stress.

Aesthetic Enhancement: The color of grout significantly influences the overall appearance of a tiled surface. It can either complement or contrast with the tile color, impacting the visual design.

Color Consistency: Advanced formulations enhance color consistency, maintaining a uniform look throughout the installation for a polished and cohesive design.

Flexibility: Offers improved flexibility, adapting to slight movements without cracking, ensuring long-lasting durability.

Ease of Application: It is user-friendly, featuring a smoother consistency and easier mixing. This simplifies the application process, resulting in professional-looking installations.

Advantages

Available in different colors

Easy to apply

Easy Maintenance

Non-cracking and No Powdering

Weather Resistant

Water Resistant

Abrasion Resistant

High Adhesion Strength



Available in 6 different colours -



We can also customize specific colors for large orders.



Directions for use

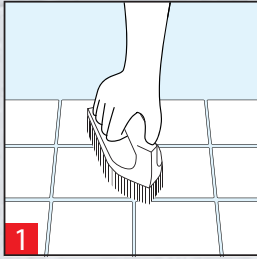

Prepare the Surface

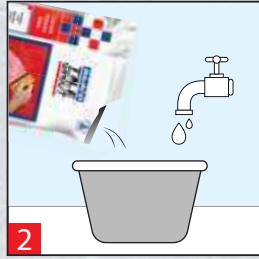

Mix Ramco Tile Grout with
32-35% of water to
powder ratio

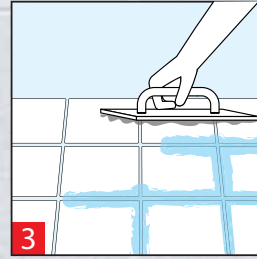

Fill the joints

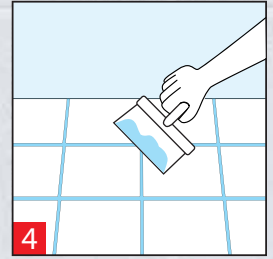

Remove excess
Tile Grout

Technical Specifications

Appearance (by visual observation) for Ramco Bright White Tile Grout	White colour powder
Water to Powder ratio (as per the required workable consistency)	32 - 35%
Pot Life	60 Minutes
Bond Strength / Adhesion Strength at 28 Day (MPa)	1.4 - 1.5
Whiteness test by Spectrophotometer analysis	95 - 100%

Right Products **for** Right Applications



Toll Free No: 1800 425 5700
www.ramcocements.in

RAMCO
CEMENT